

<div><div><div>MOKA</div><div>MOKA 研发中心 EPM产品所 平面设计室 MOKA R&D Center EPM Product Inst. 平面设计制作规范表</div></div></div>		基本内容				资料更新履历		R1	更改内文	
		品牌	JVC	销往地	USA/美国					
		物料编码	70-50D3JE-QSGZ1	机型/机芯	50D3110		BOM /批次	IMX233909B E4-50D31Q8-US3.3AU		
		物料名称	英文QSG	销售型号	LT-50EP4456W					
制作要求		工艺或使用方法								
尺寸	260 X 200 mm									
材质	230克哑粉纸									
颜色要求	四色正反双面印刷									
是否折叠或装订要求										
是否送样	是									
备注：										
制作人	蔡琮									
制作日期	2025-1-21									

This Quick Start Guide is provided so that you can properly set up your new TV

1 PACKAGE CONTENT

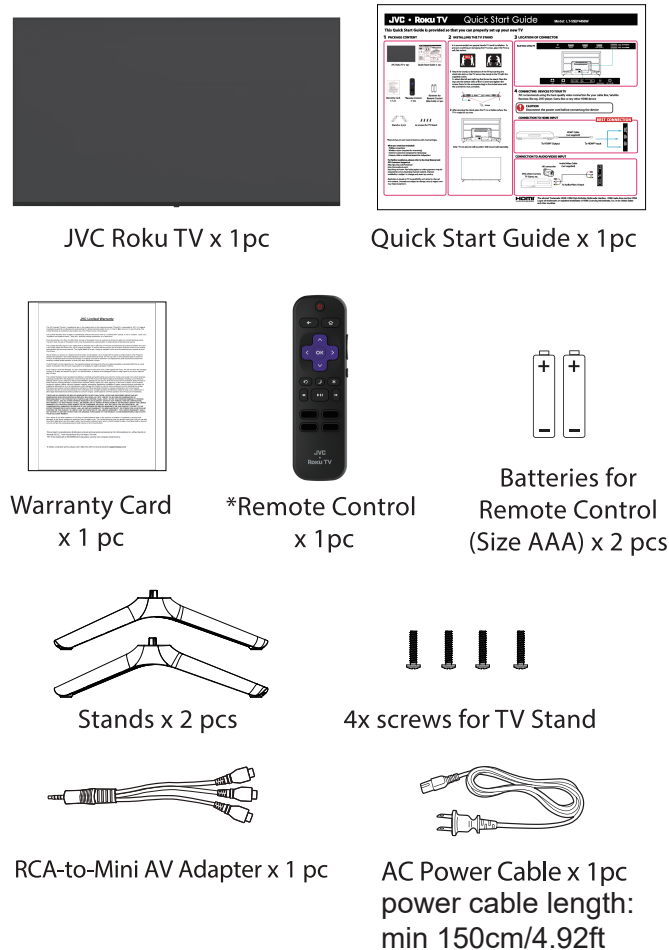

*Remote has pre-set channel buttons with channel logos.

What you need (not included)

- Phillips screwdriver
- Wireless router (required for streaming)
- Internet connection (required for streaming)
- Computer, tablet or smartphone (required for configuration)

For further assistance, please refer to the User Manual and JVC Customer Support at

<http://go.roku.com/tvmanual>

<http://jvcproducts.com/>

select "US"
Select "products"
Select "model EP series"

Key things to know: Paid subscription or other payments may be required for some streaming channel content. Channel availability is subject to change and varies by country.

Resolution is based on TV compatibility and varies by channel and content. Channels are subject to change, vary by region, and may require payment.

How do I turn the Text-to-Speech(TTs) audio guide on or off?

* Press "****" key on the remote controller four times to turn the audio guide on or off.
Or

1. Select "Settings" at home screen
2. Select "Accessibility"
3. Select "Audio Guide" and turn it on or off

*<https://tclink/tts-roku-tv>

2 INSTALLING THE TV STAND

It is recommended two people handle TV stand installation. To prevent scratching or damaging the TV screen, place the TV on a soft, flat surface.



- 1 Attach the stands to the bottom of the TV by inserting the stand into slots on the TV. Secure the stands to the TV with the supplied screws.

To attach the left and right leg that forms the stand: Place the legs into the bottom slots of the TV, insert and tighten the screws (found in the accessories bag) in the circled areas with the screwdriver (not provided).

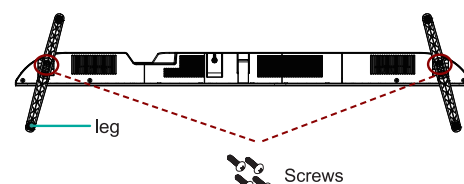

- 2 After securing the stand, place the TV on a stable surface. The TV is ready for use now.

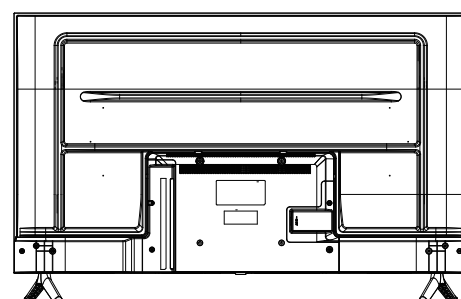

Note: TV can also be wall mounted. Wall mount sold separately.

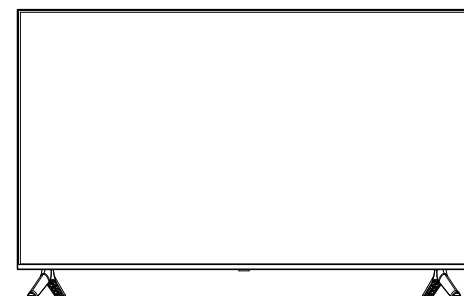

3 LOCATION OF CONNECTOR

Back View of the TV

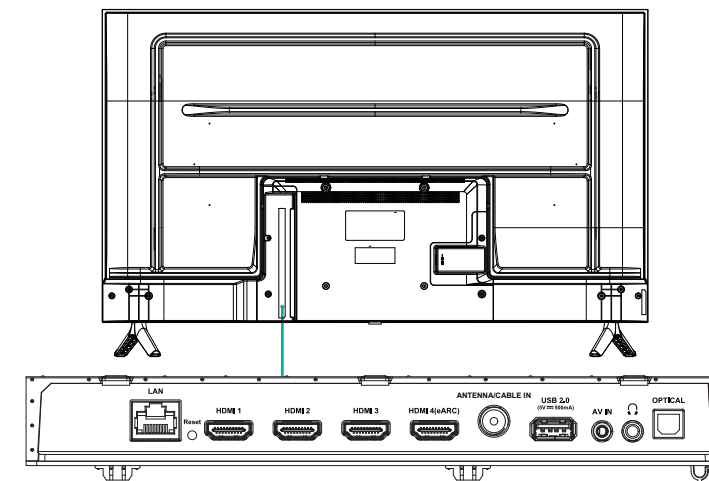

4 CONNECTING DEVICES TO YOUR TV

JVC recommends using the best-quality video connection for your cable Box, Satellite Receiver, Blu-ray, DVD player, Game Box or any other HDMI device



CAUTION

Disconnect the power cord before connecting the device

CONNECTION TO HDMI INPUT

BEST CONNECTION

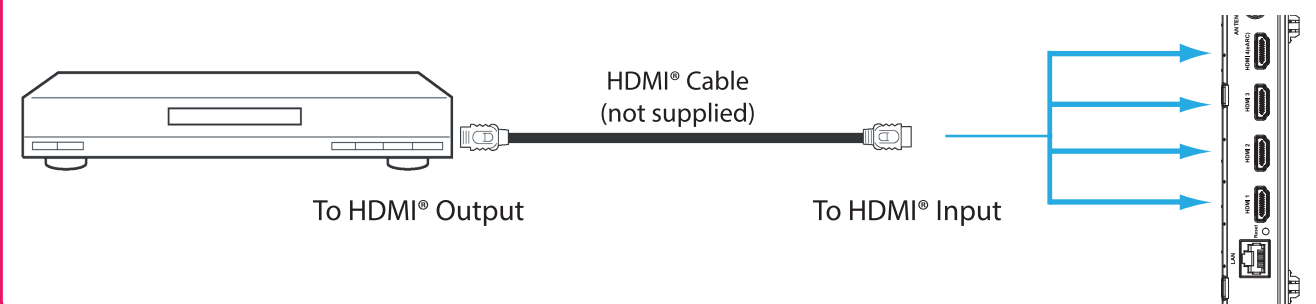

CONNECTION TO AUDIO/VIDEO INPUT

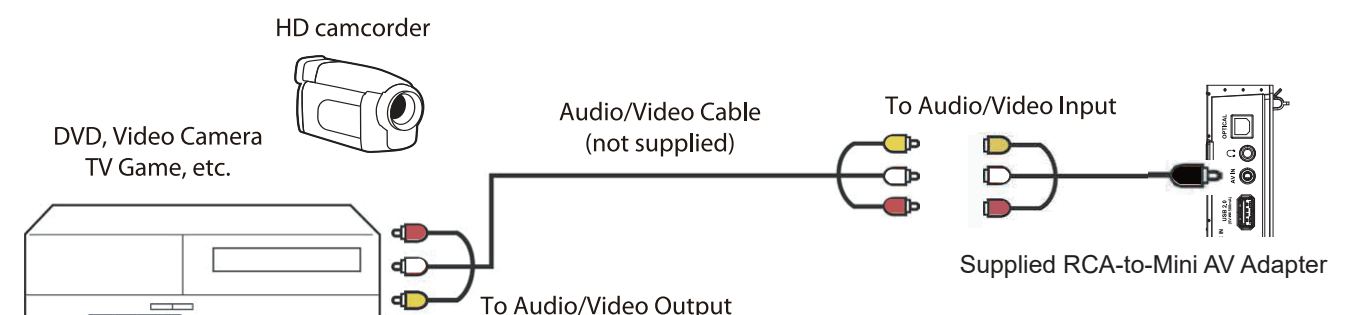

The adopted Trademarks HDMI, HDMI High-Definition Multimedia Interface, HDMI trade dress and the HDMI Logos are trademarks or registered trademarks of HDMI Licensing Administrator, Inc. in the United States and other countries.

5 SETTING UP YOUR TV

1. Place batteries in remote

Power your TV remote by inserting the included batteries carefully matching(+) and (-) indicated inside the battery compartment. Tip: Always replace dead batteries with two brand-new batteries from the same manufacturer. Never use damaged batteries. If your remote gets warm/hot during use, discontinue use and contact customer support immediately at <https://jvcproducts.com/can/contact/support.html>

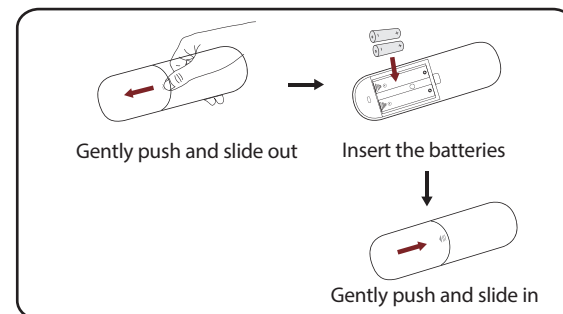

2. Plug in and turn on TV

Connect your power cord to the TV, then plug it into the wall outlet. Press the power button on your TV remote control.

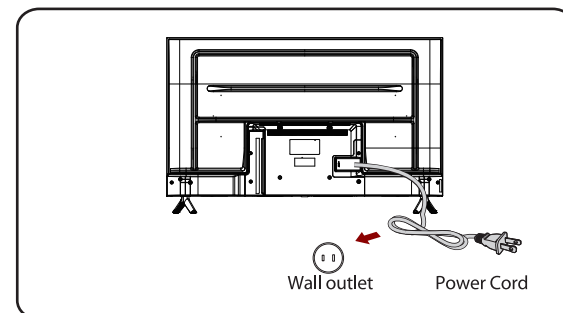

3. Complete Guided Setup and Activation

Tip: Have your wireless network name and password handy.

Follow the on-screen instructions on your Roku TV.

Activate your Roku TV using your computer, smartphone, or tablet to link to a Roku account. You need a Roku account to activate your Roku TV and access entertainment across thousands of streaming channels.

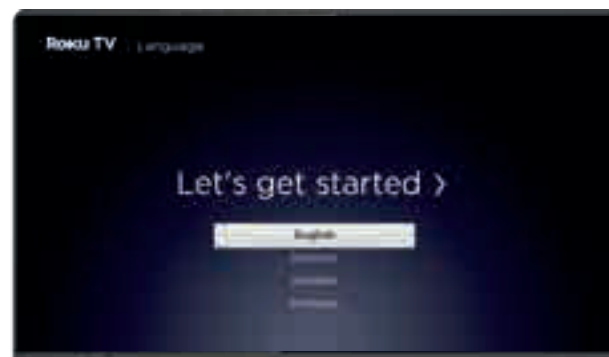

Note: Roku doesn't charge for activation support – beware of scams.

Roku accounts are free and while a valid credit card number is not required to create a Roku account, saving your credit card information makes renting, purchasing, and subscribing to entertainment from the Roku Channel Store fast and convenient.

Once connected to your account, your TV will automatically update with the latest software, and you can start streaming immediately.



If you aren't ready to connect your TV to a wireless network, you can still use it as a regular TV.

This product is manufactured, distributed, serviced and warranted exclusively by E & S International, Inc., either directly or through JSP, LLC. 7801 Hayvenhurst Avenue, Van Nuys CA 91406
"JVC" is the trademark of JVC KENWOOD Corporation, used by such company under license.
To obtain a warranty service, please call 1 (888) 582-8870 or send an email to support@jspus.com

6 CONNECT AN ANTENNA (OPTIONAL)

Check to ensure that you have selected the right cables for the ports and that they are securely. Loose connections can affect the quality of the picture image and color. (Cables and External connected Equipment not included).

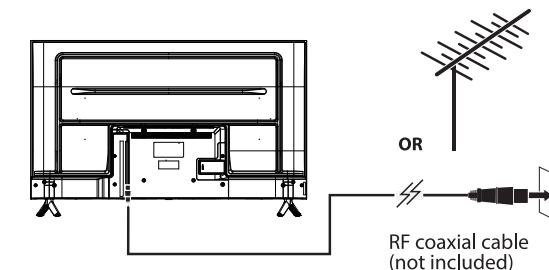

With the tuner built-in you can connect your TV to an antenna and enjoy over-the-air entertainment.

1. When the setup wizard is complete, select the Live TV icon from the home screen.
2. Follow the on-screen instructions.
3. Whenever you want to watch Live TV, select the Live TV icon.

7 REMOTE CONTROL

The Roku remote should feel right at home in your hand. We designed it to be incredibly intuitive for watching TV and navigating on-screen menus.

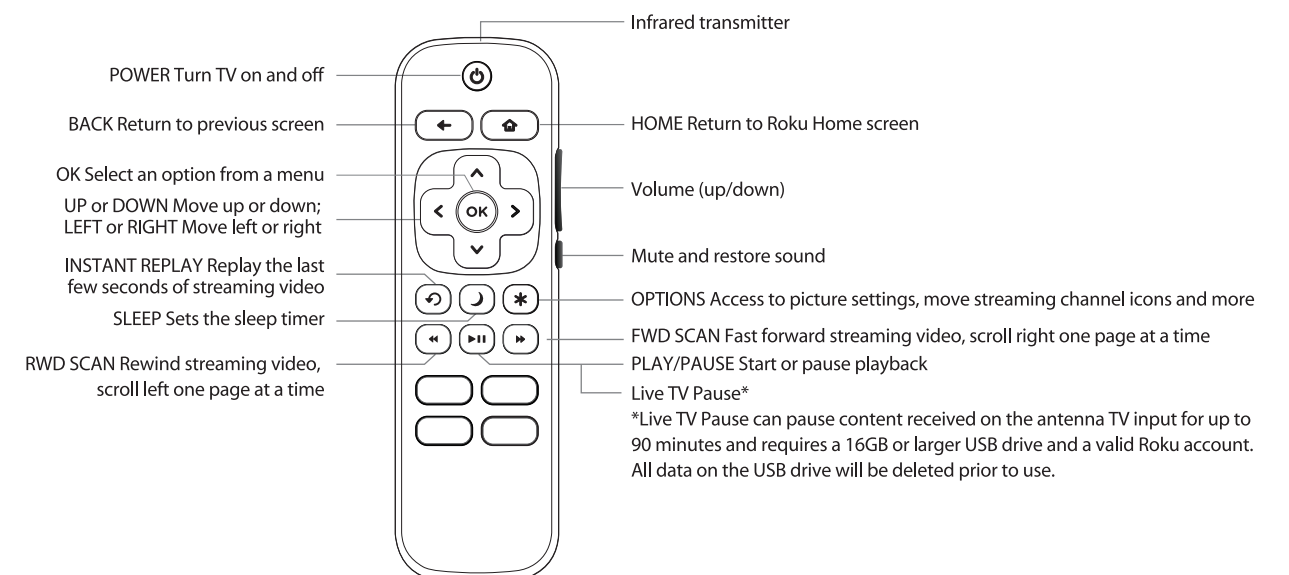

Tip: The button gives you easy access to pictures settings, display options and more. Try it on every screen.

Tip: If you prefer to use your cable box or satellite receiver remote as a universal remote, please refer to the manual provided by your cable or satellite service. It includes instructions on how to program their remote to your TV. You can find codes that work with your JVC Roku TV and universal remotes from popular cable and satellite providers at www.roku.com/universalremote.